

HDMI Distributor

MODEL A222907

Key Features

- One HDMI Source to connect up to 4 displays
- Support Full-HD 1080P resolution
- Compliant with HDMI V1.3
- Compliant HDCP V1.2
- HDCP Key sets allows each output independently
- Control by Smart I/O interface
- DDCIIB Plug & Play Function
- Distributor / Multiplexer Mode selection
- ESD protection
- Low cost



HDMI DISTRIBUTOR MODEL A222907

Chroma A222907 HDMI Distributor has HDMI signal output interface that can work with the Video Pattern Generator of Chroma to perform extended tests for HDMI signals.

This distributor has 1-In/4-Out HDMI ports that comply with the HDMI 1.3 standards to support the tests for the newest HDMI 1.3 functions.

In addition, Chroma A222907 is equipped with Distributor and Multiplexer modes that each output port can set the HDCP/EDID to be enabled or disabled concurrently or separately to facilitate the user's tests greatly.

Supporting most of CEC features which are used to communicate with HDMI network. Chroma A222907 can also output 4 CEC commands simultaneously to reduce user's test time. Depends on the showing response message from A222907 on the screen, users can verify the CEC function immediately.

In order to comply with the multi-port input design of digital FPD industry, this distributor adopts external connection with handy compact size to ease the use in variety of production lines and R&D labs.

Chroma A222907 has dynamic message function which can display HDCP key data and EDID content of TV and help users to check the data correctness.

This distributor is applicable for the Signal Generators with Smart I/O manufactured by Chroma to extend and expand the HDMI signals for various applications such as the long distance transmission of serial production line or parallel usage in demonstration room and etc. In the meantime, its special output design can be used to protect the back-end of a signal generator.

HDMI Distributor Application 1 for single unit

One A222907 has 4 outputs to test all of the HDMI ports (maximum 4) on the display directly.

HDMI Distributor Application 2 for single unit

One A222907 can output signals to 4 displays to test the EDID & HDCP functions and interpret the data separately or concurrently.

HDMI Distributor Application 3 for multiple units

Multiple A222907 can be connected in series to test even more displays for the series-parallel application of multiple devices.

HDMI Distributor Application 4 for CEC feature

One A222907 can output features to 4 different displays to test CEC function of TV independently.



PANEL DESCRIPTIONS

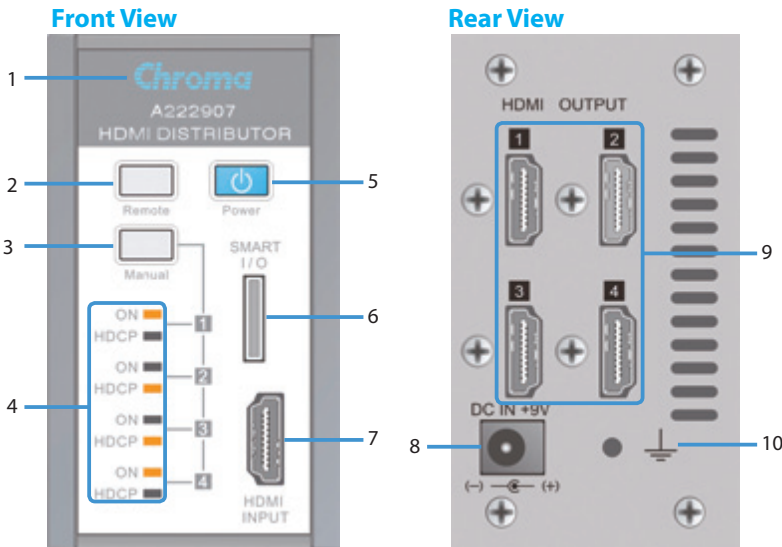

1. Logo and Power Indicator
2. Remote Switch
3. Manual Switch
4. HDMI Output Status Indicators
5. Power Switch
6. VPG SMART I/O Port
7. HDMI Input Port
8. DC Input: DC 9V Input
9. HDMI Output Ports
10. Grounding Screw

SPECIFICATIONS

OUTPUT		
Signal Format	TMDS signal Link	
Video Signal	Pixel Rate	25 to 165 MHz (TMDS CLK : 225MHz)
	Color Space	RGB, ITU-601, ITU-709, xvYcc
Audio Signal	Sampling Frequency	32 to 192 KHz
	Number of Channels	8 Channel
ESD / Surge protect (IEC 61000-4-2 Level 4 Regulation)		Contact 8KV / Air 15 KV
HDMI / HDCP		
HDMI Version	Version 1.3a	
HDCP Version	Version 1.2	
DDC	DDC2B compliant	
E-EDID	Version1.3	
CONNECTOR		
Input Signal Source from Chroma VPG Series	Equipped with Smart I/O port in 22xx / 23xx Series	
HDMI	HDMI 19 Pin x5	
Smart I/O	3 In 3 Out x1	
CEC		
Support Feature	ONE TOUCH PLAY	
	SYSTEM STANDBY	
	OSD DISPLAY	
	SET OSD NAME	
	GIVE POWER STATUS	
AUDIO CONTROL		
FRONT CONTROL MODE		
Remote Mode	Control by VPG or Manual	
Manual Mode	Output ON / OFF, or selection	
OTHER		
User Interface	Smart I/O	
DC Input	9V/2A (With Chroma adapter only)	
Temperature	Operation	+5~+40 deg.C
	Storage	-20~+60 deg.C
Humidity	20~90%	
DIMENSION & WEIGHT		
A222907 (H x W x D)	88 x 45 x 200 mm / 3.46 x 1.77 x 7.87 inch 750g / 1.65lbs	

* All specifications are subject to change without notice.

* All other brand and logo are trademarks or registered trademarks of their respective holders.

HDMI DISTRIBUTOR APPLICATIONS

Application 1

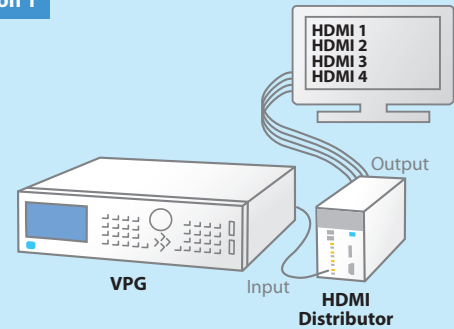

Application 2

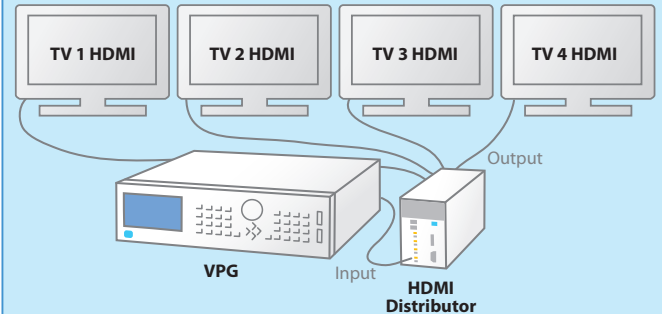

Application 3

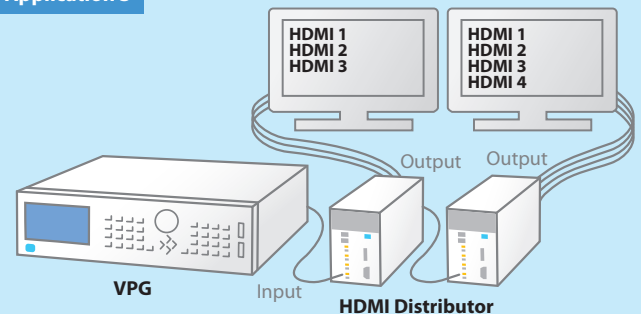

Developed and Manufactured by:

CHROMA ATE INC.

HEADQUARTERS
66 Hwaya 1st Rd., Kueishan
Hwaya Technology Park,
Taoyuan County 33383,
Taiwan
Tel: +886-3-327-9999
Fax: +886-3-327-8898
http://www.chromaate.com
E-mail: info@chromaate.com

**CHINA
CHROMA ELECTRONICS
(SHENZHEN) CO., LTD.**
8F, No.4, Nanyou Tian An
Industrial Estate, Shenzhen,
China PC: 518052
Tel: +86-755-2664-4598
Fax: +86-755-2641-9620

**JAPAN
CHROMA JAPAN CORP.**
472 Nippa-cho, Kouhoku-ku,
Yokohama-shi, Kanagawa,
223-0057 Japan
Tel: +81-45-542-1118
Fax: +81-45-542-1080
http://www.chroma.co.jp
E-mail: info@chromaate.com

**U.S.A.
CHROMA ATE INC. (U.S.A.)**
7 Chrysler Irvine, CA 92618
Tel: +1-949-421-0355
Fax: +1-949-421-0353
Toll Free: +1-800-478-2026
http://www.chromaus.com
E-mail: info@chromaus.com

**EUROPE
CHROMA ATE EUROPE B.V.**
Morsestraat 32, 6716 AH Ede,
The Netherlands
Tel: +31-318-648282
Fax: +31-318-648288
http://www.chromaeu.com
E-mail: sales@chromaeu.com

Worldwide Distribution and
Service Network